

# HAVEN



## 105/215 Cottesloe Drive Mermaid Waters QLD

2 2 1

Spacious North facing townhouse embracing natural light and canal breezes. Close to Pacific Fair and Robina Town Shopping Centres, Mermaid Beach, trendy Nobbys Beach precinct and Bond University. Walking distance to local schools, Pizzey Park, IGA, transport and the best a Gold Coast lifestyle has to offer.

- Light filled, North facing townhouse in sought after 'Sailfish Cove'
- Tiled open plan living and dining area, neutral tones throughout
- Tidy kitchen with breakfast bar, dishwasher and European laundry
- Bedrooms with built in's and balconies, master with renovated ensuite
- Low maintenance lot with tranquil and leafy private courtyard

**Price** : \$ 540,000

**View** : <https://www.havenestateagents.com.au/sale/qld/gold-coast/mermaid-waters/residential/townhouse/7546500>



**Carl English**  
0416 811 429

<https://www.havenestateagents.com.au>

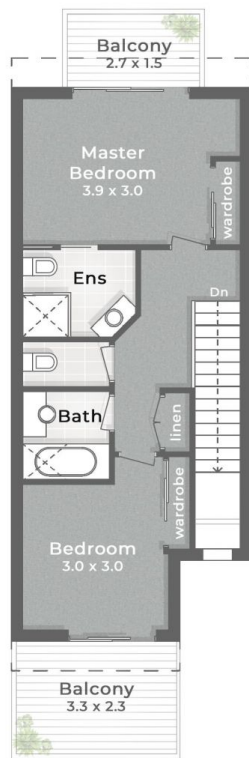

:: FLOOR PLAN  
First Floor

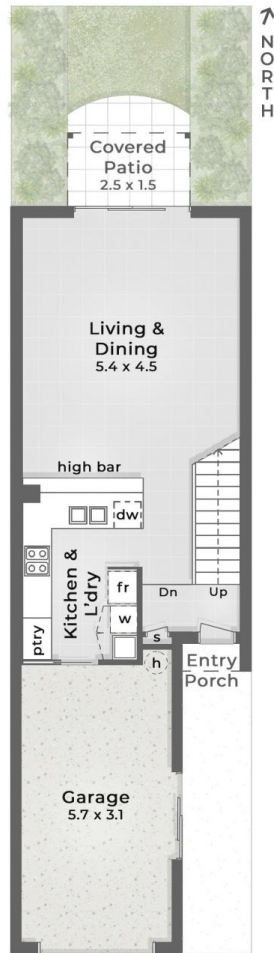

:: FLOOR PLAN  
Ground Floor

#### POINTS OF INTEREST

1. SAILFISH COVE
2. Pacific Fair Shopping Centre
3. James Street
4. Treetops Shopping Plaza
5. Christine Corner Shopping Centre
6. Miami One Shopping Centre
7. Nobby's Beach Cafes, Restaurants and Bars
8. Miami State High School
9. Pizzezy Park Sporting Complex

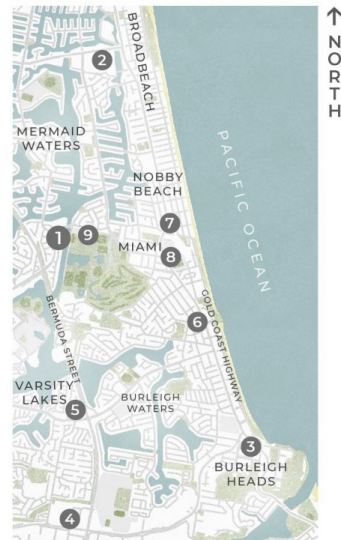

:: LOCATION MAP

# HAVEN

Carl English  
0416 811 429

#### SAILFISH COVE

105/215 Cottesloe Drive  
MERMAID WATERS

2 Bed

2 Bath

1 Car  
+ Off-Street

Internal 114m<sup>2</sup>  
External Areas 17m<sup>2</sup>  
Total 131m<sup>2</sup>

pdc.

This is not a legal document therefore all measurements and information provided is subject to survey. No permission is given to use or alter this Floor Plan without the consent of Pure Design Concepts. The overall presentation style, layout, imagery, fonts, background, colours and terminology has been originally created by PDC and is subject to strict copyright. No ownership is taken of building design. Find out more at [puredesignconcepts.com.au](http://puredesignconcepts.com.au)